



**Tailte
Éireann**

Clárúchán, Luacháil,
Suirbhéireacht
Registration, Valuation,
Surveying

Tailte Éireann Sealed and Certified Copy Folio (& Title Plan)

MULLANEYS SOLICITORS
DX 5009
SLIGO

This page forms part of the official document. Do not detach.

Folio Number: SL296
Application Number: P2025LR073967K
Your Reference: MM/Mc115-9



This document comprises a sealed and certified copy of the Tailte Éireann record for the above mentioned folio/title plan as of the date appearing.

Details of **dealings pending** (if any) are listed in the **Schedule** below.

An officer duly authorised by Tailte Éireann



Schedule

Notes:

1. Title plans should be read in conjunction with the folio. The description of the land on the folio or on the title plan is not conclusive as to the boundaries or extent of the land (see Section 85 of the Registration of Title Act 1964, as substituted by Section 62 of the Registration of Deeds and Title Act, 2006).
2. Title plans greater than A3 in size may be provided as separate A3 tiles with an overlap and print gutter. When aligning the tiled sheets, customers are advised to use the underlying topographical detail.
3. On receipt of this record, please check to verify that all the details contained therein are correct. If this is not the case, please return the document to Tailte Éireann immediately.

Land Registry

County Sligo**Folio 296****Register of Ownership of Freehold Land****Part 1(A) - The Property**

Note: Unless a note to the contrary appears, neither the description of land in the register nor its identification by reference to the Registry Map is conclusive as to boundaries or extent.

For parts transferred see Part 1(B)

No.	Description	Official Notes
1	<p>A plot of ground being part of the Townland of BARNASRAHY and Barony of CARBURY containing 6.4193 Hectares shown as Plan(s) 296 edged RED on the Registry Map (OS MAP Ref(s) 14/10).</p> <p>The Registration does not extend to the mines and minerals</p>	

Land Registry

County Sligo

Folio 296

Part 1(B) - Property
Parts Transferred

No.	Prop No.	Instrument	Date	Area(Hectares)	Plan	Folio No.

Land Registry

County Sligo

Folio 296

Part 2 - Ownership

Title ABSOLUTE

No.	The devolution of the property is subject to the provisions of Part II of the Succession Act, 1965	
1	08-NOV-1995 95SM07475	Agatha McGee (Farmer) of Barnashragh, County Sligo is full owner.

Land Registry

County Sligo

Folio 296

Part 3 - Burdens and Notices of Burdens

No.	Particulars
1	<p>The property is subject to the provisions prohibiting letting, subletting or subdivision specified in Section 12 of the Land Act, 1965, and to the provisions restricting the vesting of interests specified in Section 45 of the said Act in so far as the said provisions affect same.</p> <p>Cancelled D2015LR035470N 19-MAR-2015</p>
2	<p>14-MAR-1996 96SM01857</p> <p>Charge for present and future advances stamped to cover £50000 repayable with interest.</p> <p>The Governor and the Company of the Bank of Ireland is owner of this charge.</p> <p>Note: This charge is also registered on Folio SL297 and Folio SL11555F</p> <p>Cancelled D2015LR073249Y 04-JUN-2015</p>
3	<p>21-DEC-2000 D2000SM009715Y</p> <p>The charge at entry no. 3 extends to advances up to and including £106,000 being the amount covered by the Revenue Duty impressed on the original deed of charge dated the 9th February 1996, a certified copy of which is filed on Instrument no. D2000SM009715Y.</p>
4	<p>19-MAR-2015 D2015LR035470N</p> <p>Charge for present and future advances repayable with interest.</p> <p>ULSTER BANK IRELAND LIMITED is owner of this charge.</p> <p>Note: This charge is registered on folios SL296, SL297, SL22156, SL2296F.</p> <p>Note: The ownership of this charge has been transferred. See Entry No.5</p>
5	<p>09-JUN-2023 D2023LR088779W</p> <p>ALLIED IRISH BANKS P.L.C. is the owner of the charge registered at Entry No.4</p>



Tailte Éireann
Clárúchán, Luacháil,
Suirbhéireacht
Registration, Valuation,
Surveying

565770 mE, 835950 mN

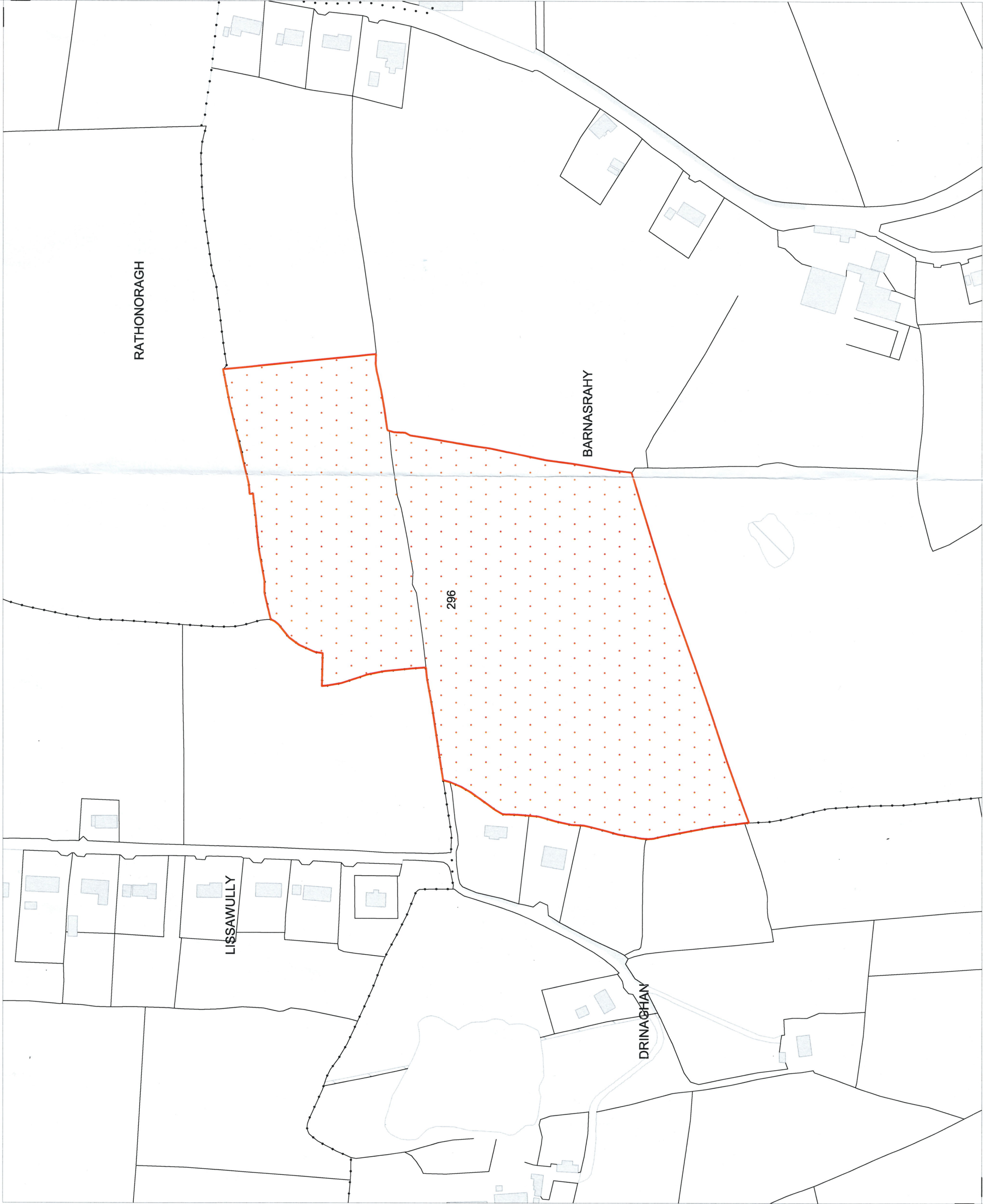

Folio: SL296

This map should be read in conjunction with the folio.

Tailte Éireann (TÉ) Registration mapping is based on TÉ Surveying mapping. Where TÉ Registration maps are printed at a scale that is larger than the TÉ Surveying scale, accuracy is limited to that of the TÉ Surveying map scale.

For details of the terms of use and limitations of scale, accuracy and other conditions relating to TÉ Registration maps, see www.tailte.ie.

This map incorporates TÉ Surveying map data under licence from TÉ. Copyright © Tailte Éireann and Government of Ireland.

(centre-line of parcel(s) edged)

Freehold

Leasehold

SubLeasehold

Burdens (may not all be represented on map)

Right of Way / Wayleave

Turbary

Pipeline

Well

Pump

Septic Tank

Soak Pit



A full list of burdens and their symbology can be found at: www.landdirect.ie

Tailte Éireann Registration operates a non-conclusive boundary system.

The TÉ Registration map identifies properties not boundaries meaning neither the description of land in a folio nor its identification by reference to a TÉ Registration map is conclusive as to the boundaries or extent. (see Section 85 of the Registration of Title Act, 1964). As inserted by Section 62 of the Registration of Deed and Title Act 2006.



1:2500 Scale